

CANTILEVER SYSTEM

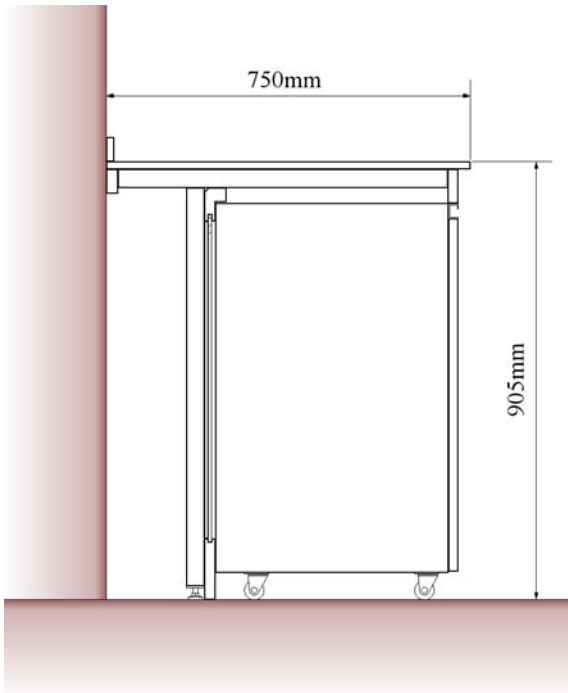

- WORKTOPS SUPPORTED ON TUBULAR STEEL FRAMES
- SPACE UNDERNEATH FULLY FLEXIBLE (open or with units)
- MOBILE OR MOVABLE UNITS
- RANGE OF WORKTOP MATERIALS
- OPTIONAL REMOVABLE SERVICE PANELLING (not shown)

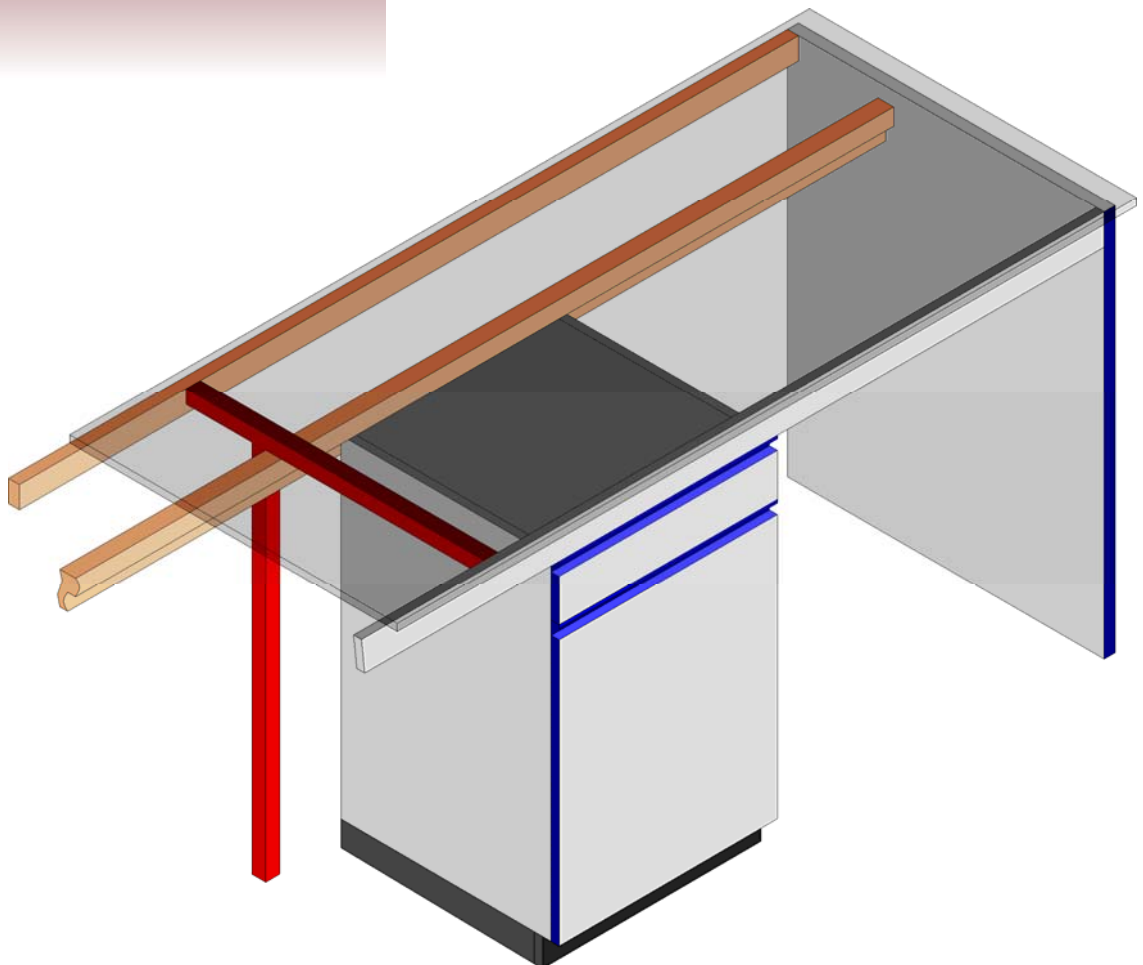

Unit Options

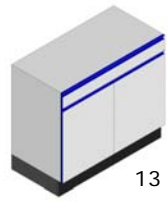
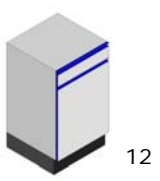
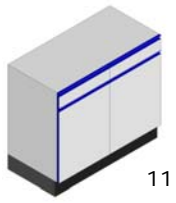

Cupboard & Drawer Units

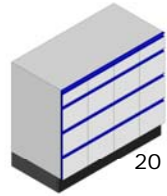
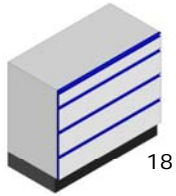

Drawer Units

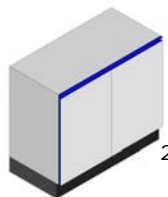
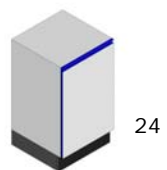
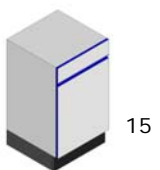
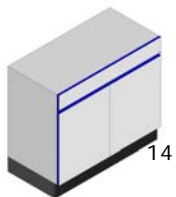

Cupboard Units

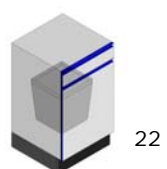
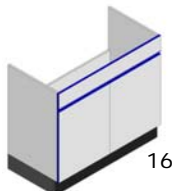

Sink Cupboards

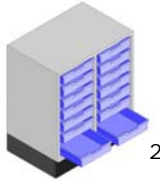
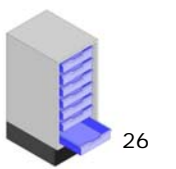

Open Tray Units

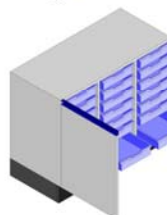
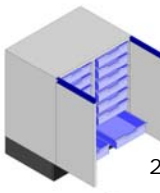
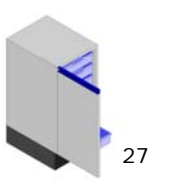

Tray Units with Doors

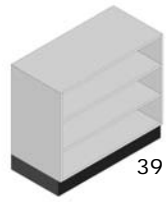
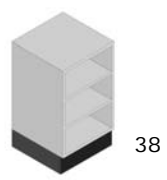
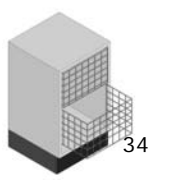

Special Units

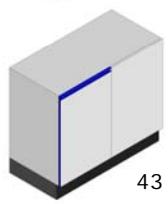
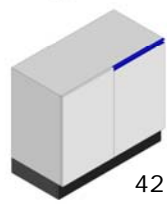
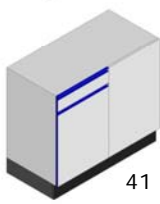
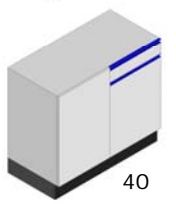

Corner Units

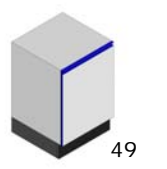
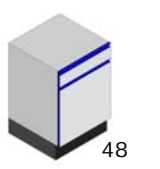
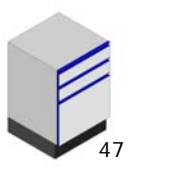

Low Height Units